



# USER MANUAL



**240v 11,500Btu  
Air Conditioner V2**

**Product Code:  
SP11500ACV2**

Serial Number Range:

From:

To:

Year Of Manufacture:



**\*Please note, when ordering online via our website if the part number is not recognised, please Email [spares@hscgroupuk.co.uk](mailto:spares@hscgroupuk.co.uk) or Telephone 0115 946 1988**

**KEEP THIS BOOKLET FOR FUTURE REFERENCE**

📞 Nottingham: 0115 946 1988 • London: 0208 830 3333    ✉ Nottingham: [sales@hscgroupuk.co.uk](mailto:sales@hscgroupuk.co.uk) • London: [sean@hscgroupuk.co.uk](mailto:sean@hscgroupuk.co.uk)    🌐 [www.hscgroupuk.co.uk](http://www.hscgroupuk.co.uk)

The Hire Supply Company Terms & Conditions Apply At All Time E&OE



# AIR CONDITIONER

## SP11500AC

### USER MANUAL

CONTROLLED DOCUMENT NO: 00100UIRS0321V2

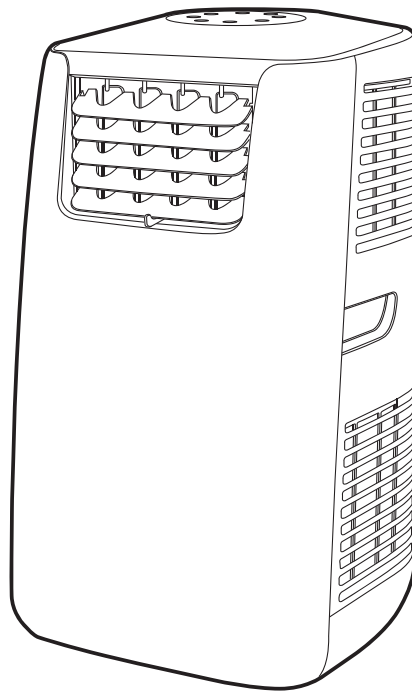

### IMPORTANT SAFETY INSTRUCTIONS

Before using this SP11500AC please read this user manual, if you do not understand any of the instructions within please do not use and consult your retailer or the manufacturer for clarification.

Failure to follow these instructions may result in damage to the product, property or cause personal injury.

**KEEP THIS BOOKLET FOR FUTURE REFERENCE**

---

## Operating Instructions.

Thank you for purchasing an Simply Spares product, manufactured to a high standard, this product will, if used in accordance with these operating instructions, labels affixed to the product and properly maintained, provide you with many years of reliable services.

**IMPORTANT:** PLEASE READ THESE INSTRUCTIONS CAREFULLY. NOTE THE SAFE OPERATIONAL REQUIREMENTS, WARNINGS & CAUTIONS. USE THE PRODUCT CORRECTLY FOR THE PURPOSE TO WHICH IT IS INTENDED. FAILURE TO DO SO MAY RESULT IN DAMAGE AND/OR PERSONAL INJURY AND WILL INVALIDATE YOUR WARRANTY. KEEP THESE INSTRUCTIONS SAFE FOR FUTURE USE.



Read user instructions **BEFORE** using this product



This appliance is filled with Propane gas R290.  
Strictly follow the manufacturer's instruction  
concerning use and repairs



Refer to user manual before undertaking any  
maintenance or repairs

## **BEFORE USE - GENERAL SAFETY**

- FOR INDOOR USE ONLY.
- LEAVE THE UNIT TO STAND FOR 12HRS BEFORE CONNECTING TO THE POWER SUPPLY AFTER TRANSPORTATION OR AFTER MOVING.
- ONLY USE THE APPLIANCE IN THE UPRIGHT POSITION AND ON A FLAT LEVEL SURFACE (Fig. 1 )
- ONLY TRANSPORT THE APPLIANCE IN AN UPRIGHT POSITION ON A FLAT LEVEL SURFACE.
- ENSURE A 50CM GAP IN MAINTAINED AROUND THE APPLIANCE FROM ANY OBJECTS (Fig. 4)
- DO NOT PLACE OBJECTS ON THE UNIT OR RESTRICT AIR INLET /OUTLET (Fig. 2,3).
- SUPERVISE ANY CHILDREN AND/OR PETS WITHIN THE VACINITY IN WHICH THE APPLIANCE IS USED.
- THIS APPLIANCE IS NOT INTENDED FOR USE BY PERSONS (INCLUDING CHILDREN) WITH REDUCED PHYSICAL, SENSORY OR MENTAL CAPABILITIES, OR LACK OF EXPERIENCE AND KNOWLEDGE, UNLESS THEY HAVE BEEN GIVEN SUPERVISION OR INSTRUCTION CONCERNING USE OF THE APPLIANCE BY A PERSON RESPONSIBLE FOR THEIR SAFETY. CHILDREN SHOULD BE SUPERVISED TO ENSURE THAT THEY DO NOT PLAY WITH APPLIANCE.

## **ELECTRICAL SAFETY**

- SWITCH OFF AND UNPLUG WHEN NOT IN USE.
- NEVER LEAVE A FUNCTIONING DEVICE UNSUPERVISED.
- DO NOT USE IN HUMID OR WET ENVIRONMENTS (Fig. 3)
- DO NOT PULL THE APPLIANCE ALONG BY THE POWER CORD.
- AVOID TWISTING , COILING AND PULLING THE POWER CORD, DO NOT USE WIRE OR SHARP NYLON TIES AS THESE MAY DAMAGE THE CORD INSULATION.
- IF THE SUPPLY CORD IS DAMAGED, IT MUST BE REPLACED BY AN ELECTRICIAN OR SIMILARLY QUALIFIED PERSON, TO AVOID HAZARD.
- THE MAINS SUPPLY MUST CONFORM TO THE SPECIFICATION SHOWN ON THE RATING PLATE AT THE BACK OF THE UNIT.
- ENSURE THE PLUG AND SOCKER USED TO POWER THE APPLIANCE IS EASILY ACCESSIBLE AT ALL TIMES WHEN IN USE.
- DO NOT USE EXTENSION CORDS TO POWER THE APPLIANCE.
- THIS APPLIANCE SHALL BE USED IN ACCORDANCE WITH THE NATIONAL WIRING REGULATIONS.

## **OPERATING RESITRICTIONS**

- DO NOT USE THIS APPLIANCE IN CONFINED SPACES WITH RESITRICTED ACCESS
- DO NOT OPERATE IN ROOMS SMALLER THAN 13m<sup>2</sup>
- DO NOT USE IN HUMID OR WET ENVIRONMENTS (Fig. 3)
- DO NOT USE THE APPLIANCE IN POTENTIALLY EXPLOSIVE ENVIRONMENTS CONTAINING COMBUSTIBLE LIQUIDS, GASES OR DUSTS.
- DO NOT USE PAINT, CLEANING SPRAYS, INSECT REPELLANTS NEAR OR ON THE APPLIANCE AS THIS MAY DAMAGE THE PLASTIC HOUSING OR INTERNAL ELECTRICAL COMPONENTS

### **TO ENSURE MAXIMUM EFFICIENCY**

- CLOSE DOORS AND WINDOWS
- KEEP FILTERS CLEAN
- DO NOT EXCEED THE RECOMMENDED ROOM SIZE FOR MAXIMUM EFFICIENCY.
- KEEP CURTAINS AND BLINDS CLOSED DURING THE SUNNIEST HOURS OF THE DAY.
- ONCE ROOM HAS REACHED THE DESIRED CONDITIONS, REDUCE TEMPERATURE AND VENTILATION SETTING

### **SERVICE AND MAINTENANCE**

- DO NOT USE IF YOU HAVE NOTED DAMAGE TO THE APPLIANCE, POWER CORD OR PLUG, IF THE APPLIANCE IS MALFUNCTIONING OR IF THERE ARE ANY OTHER SIGNS OF ANY DEFECTS. RETURN THE COMPLETE PRODUCT TO THE YOUR VENDOR OR THE MANUFACTURERS NOMINATED AGENT FOR INSPECTION OR REPAIR.
- PERIODIC CLEANING OF FILTERS IS RECOMMENDED BASED ON USEAGE AND ENVIRONMENT USED.
- USE A SOFT DAMP CLOTH WITH A MILD DETERGENT TO CLEAN THE APPLIANCE. DO NOT USE ABRASIVE CLEANERS.
- ONLY A LICENSED PROFESSIONAL IS ALLOWED TO DISMANTLE, SERVICE OR REPAIR THE APPLIANCE.
- THE MACHINE IS TO BE USED ONLY FOR ITS PRESCRIBED PURPOSE. ANY OTHER USE IS DEEMED TO BE A CASE OF MISUSE. THE USER/OPERATOR, NOT THE MANUFACTUER WILL BE LIABLE FOR ANY DAMAGE OR INJURIES OF ANY KIND CAUSED AS A RESULT OF THIS.

### **SAFETY REGARDING THE R290 REFRIGERANT**

- THIS APPLIANCE CONTAINS R290 REFRIGERANT COMPLIANT WITH THE CURRENT EUROPEAN DIRECTIVES.
- NEVER PERFORATE THE REFRIGERANT CIRCUIT, R290 IS FLAMMABLE.
- R290 GAS HAS A LOW ENVIRONMENTAL IMPACT (GWP3) AND EXCELLENT THERMODYNAMIC PROPERTIES.
- DO NOT USE MEANS TO ACCELERATE THE DEFOSTING PROCESS.
- DO NOT USE ANY OTHER CLEANING PRODUCTS OR METHODS OTHER THAN RECOMMENDED BY THE MANUFACTURE.
- DO NOT STORE THE APPLIANCE IN ROOMS WITH CONTINUOUSLY OPERATING IGNITION SOURCES – SUCH AS WATER HEATERS, BOILERS OR ELECTRIC HEATERS.
- DO NOT PIERCE OR BURN ANY OF THE COMPONENTS OF THE COOLING CIRCUIT.
- DO NOT SET ALIGHT THE APPLIANCE.
- IT IS RECOMMENDED THE ORIGINAL PACKAGING BE USED FOR LONG TERM STORAGE OF THE APPLIANCE TO PREVENT DAMAGE FROM OCCURING.
- REFRIGERANTS MAY NOT CONTAIN AN ODOUR, YOU MAY NOT SMELL ANY LEAKS.
- APPLIANCE SHOULD BE INSTALLED, OPERATED IN A ROOM WITH A FLOOR AREA LARGER THAN 13m<sup>2</sup>
- COMPLIANCE WITH NATIONAL GAS REGULATIONS SHALL BE OBSERVED
- KEEP ALL VENTILATION APERTURES AND LOUVERS CLEAR OF OBSTRUCTIONS.
- STORE THE APPLIANCE IN A WELL-VENTILATED AREA CORRESPONDING IN SIZE TO THE MINIMUM OPERATING REQUIREMENTS (13m<sup>2</sup>)
- ANY PERSON WHO IS INVOLVED WITH WORKING ON OR BREAKING INTO A REFRIGERANT CIRCUIT SHOULD HOLD A CURRENT VALID CERTIFICATE FROM AN INDUSTRY ACCREDITED ASSESSMENT AUTHORITY. THIS AUTHORISES THEIR COMPETENCE TO HANDLE REFRIGERANTS SAFELY IN ACCORDANCE WITH AN INDUSTRY RECOGNISED ASSESSMENT SPECIFICATION.
- SERVICING SHALL ONLY BE PERFORMED ON THE GROUNDS AS RECOMMENDED BY THE APPLIANCE MANUFACTURER. MAINTENANCE AND REPAIR REQUIRING THE ASSISTANCE OF OTHER SKILLED PERSONNEL SHALL BE CARRIED OUT UNDER THE SUPERVISION OF THE PERSON COMPETENT IN THE USE OF FLAMMABLE REFRIGERANTS.

# AIR CONDITIONER

## DIAGRAMS FOR CORRECT INSTALLATION AND USE

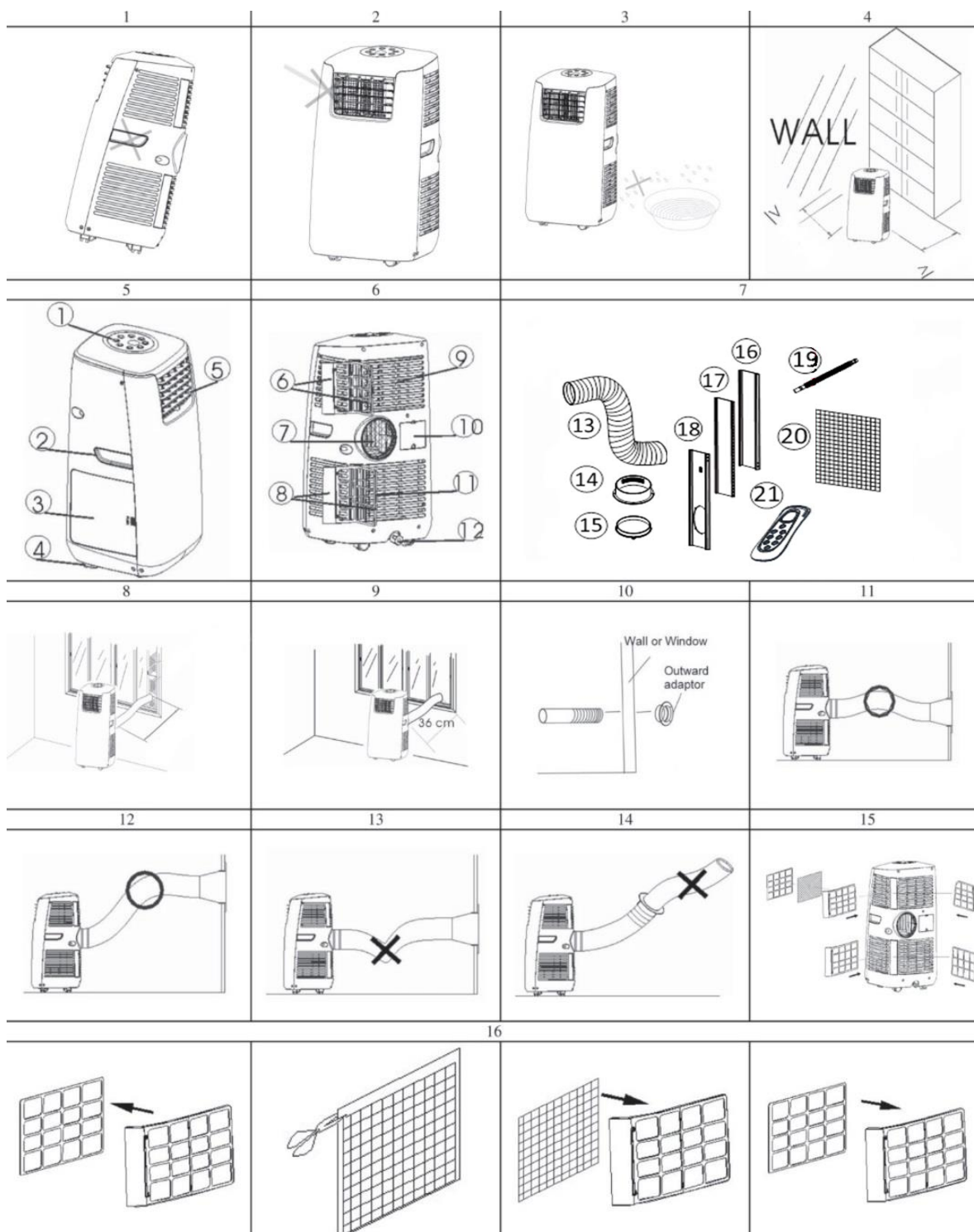

<p>17</p>	<p>18</p> <p>1. Open the door for the water tank</p> <p>2. Take out the water tank</p> <p>3. Unscrew the tap for the tank and fill up the tank with clean water</p> <p>Tap for water tank</p>		
<p>19</p> <p>Water hole</p> <p>Rubber plug</p> <p>Drain knob</p>	<p>20</p> <p>Rubber plug</p> <p>Drain knob</p>	<p>21</p> <p>Drain tube</p>	<p>22</p> <p>Original drain tube</p> <p>Extended drain tube(OD: 18mm)</p>
<p>23</p> <p>Power cord inside</p>	<p>Only for SP11500AC</p> <p>13, 14, 15, 16, 17, 18, 19, 20, 21</p>		

## TECHNICAL DATA

<b>MODEL</b>	<b>SP11500AC</b>
Power/Ampere consumption for cooling	1300W / 5.8A
Air volume (max. speed)	410m <sup>3</sup> /h
Humidity removal capacity	1.4Uhour
Power supply	220-240V-. 50Hz
Compressor	Rotary
Refrigerant	R290
Fan speed	3
Timer	1 - 24 hours
Working temperature	Cooling: 18 -32°C
Exhaust pipe	Ø142 x 1500mm
Net Weight	28.5kgs
Dimension	420 x 405 x 790 mm (L x W x H)

Remark:

- Measuring condition for below is as per EN 14511:  
Cooling: DB= 35°C, WB=24°C  
\*DB- temperature of dry bulb=room temperature,  
\*WB\* - temperature of web bulb = relative humidity
- Test condition for data in our rating label is as per safety regulation EN 60335-2-40





## PARTS

### Front (Fig. 5)

1. Control Panel
2. Air vent
3. Handle
4. Castor
5. Air outlet

### Back (Fig. 6)

6. Air filter
7. Exhaust air outlet
8. Air filter
9. Air inlet
10. Cord storage
11. Air inlet
12. Water stopper/drainage point

## INSTALLATION OF THE EXHAUST PIPE

The unit is a portable air conditioner that may be moved from room to room.

1. Using the adaptor (fig.9, 10)
  - Cut a 152mm diameter hole in the wall or window.
  - Feed exhaust hose through the window or wall and attach the threaded adaptor from the outside as shown.
  - When not in use, plug the hole with the cover provided.

### MOUNTING OF THE EXHAUST PIPE (Fig. 11-14)

- Use only the hose provided and clip exhaust hose and unit adaptor to the back of the air conditioner.
- Avoid kinks and bends in the exhaust hose as this will cause expelled moist air to build up causing the unit to overheat and shut down. Fig 8 & 9 show correct position.
- The hose may be extended from 300mm to 1500mm but for maximum efficiency use the shortest length possible.

### MOUNTING OF THE EXHAUST PIPE USING A WINDOW SPACER (Fig. 7)

- Offer window spacer to the window gap and adjust the length as required.
- Pass the exhaust through the window spacer to the outside.
- Close the window to retain the spacer securely in position. The method of fixing is also suitable for sash windows.
- Take care to ensure the window and spacer is secure against intruders.
- Consideration should be made to the outside area of the duct - could the condensate of warm air present a hazard or nuisance?

#### **WARNING!**

The length of the exhaust pipe is specially designed according to the specification of this product. Do not replace or prolong it with your own private hose as this could cause the unit to malfunction.

## Accessories (Fig, 7)

13. Exhaust hose.
14. Adaptor - for insertion over hose and into window spacer (or into hole in the wall/window).
15. Cover for adaptor
16. Window spacer - for filling the open window.
17. Window spacer - for filling the open window.
18. Window spacer with hole for exhaust duct
19. Drain tube for continuous drainage
20. Active carbon filter
21. Remote control

## INSTALLATION OF THE CARBON FILTER (Fig. 15, 16)

1. Draw out the filter frame from the unit.
2. Remove the filter fixer from the filter frame.
3. Remove the active carbon filter from its plastic bag.
4. Insert the active carbon filter into the filter frame.
5. Fix the filter by reassembling the fixer onto the filter frame.
6. Re-fit the filter frame inside the unit.

## OPERATION

### Control panel (Fig. 17)

1. ON/OFF button
2. MODE button
3. TEMPERATURE UP button
4. TEMPERATURE DOWN button
5. SPEED (ventilation) button
6. TIMER button
7. SLEEP button
8. IONIZER button (optional)
  - a. Display window
  - b. Heating operation indicator (optional)
  - c. Automatic mode indicator
  - d. Cooling operation indicator
  - e. Fan operation indicator
  - f. High ventilation indicator
  - g. Medium ventilation indicator
  - h. Low ventilation indicator
  - i. Receiver for remote control
  - j. Timer operation indicator
  - k. Sleep function operation indicator
  - l. IONIZER operation indicator

## TURNING ON/OFF

- Press ON/OFF button, the unit will work in cool mode with low fan speed, the pre-setting temperature is 24°C.
- Indicators of the functions in progress come on at the same time. \*NOTE! The display window shows the ambient room temperature from 0°C to 50°C
- To turn the unit off, press ON/OFF button again.
- If the air conditioning unit experiences an unexpected power failure or power surge upon restarting please observe a 3 minute delay after returning power before selecting cooling mode. Failure to follow this procedure will cause a high inrush power surge potentially resulting in blowing the mains inlet fuse located in the plug. This may also occur if the unit is not shut down correctly i.e. removing the power from the unit without turning off using the on/off button first.

## SETTING MODE/FUNCTION

Press MODE button to select required working mode: cooling, fan or heating, (Heating is only available for heating models).

## SETTING TEMPERATURE

1. Press Temperature up' or Temperature down' button to regulate the temperature you desire.
2. The display window will show the temperature you set as you press 'Temperature up' or 'Temperature down' button. Otherwise, it will always show the ambient temperature.
3. The pre-setting temperature of this machine is: 24°C for cooling.

## SETTING VENTILATION SPEED

Press SPEED button to choose the ventilation speed you need, high or low. The sign of high or low ventilation will light on at the same time.

## EFFICIENCY BOOSTING (fig. 18)

This unit is equipped with “energy efficiency boosting” function, by adding the water to the water tank as below, the energy efficiency can be boosted, save energy for the earth, save money for you.

1. Open the door for the water tank
2. Take out the water tank

## EFFICIENCY BOOSTING (fig. 18)

This unit is equipped with “energy efficiency boosting” function, by adding the water to the water tank as below, the energy efficiency can be boosted, save energy for the earth, save money for you.

1. Open the door for the water tank
2. Take out the water tank
3. Unscrew the tap for the tank and fill up the tank with clean water

## SETTING TIMER

1. Press TIMER button to set the operating hours you desire (1 to 24 hours, the sign of timer will light on). When the set time has been reached, the machine will turn off automatically. The display window will show the hour(s) you set as you press TIMER button. If the timer button is not pressed, the unit will work continuously.
2. By pressing the timer but without turning on the other functions, you can PRE-SET the time for the machine to work. For example, if you press the timer to '2', the unit will work automatically after 2 hours.

## SLEEP FUNCTION

1. In cooling mode, by pressing the SLEEP button, the set temperature will increase 1°C at the 1st hour, another 1°C at the second hour, then keeps at that temperature.
2. In sleep mode, the ventilation will keep at low speed. Repress the SLEEP button, the setting temperature and ventilation speed will return to the pre-selected one.
3. The unit will shut down automatically after the SLEEP function running for 12 hours.
4. Please note, the sleep function is not available while the machine is working in ventilation, dehumidification or auto mode. Only available in Cooling.
5. When the machine is in sleeping function, the Fan Speed would turn to be LOW speed.

## IONIZER FUNCTION (OPTIONAL)

This is only for the model with Ionizer function.

To start the ionizer function, please press IONIZER button, this function can push away the dust and large particles in the air.

## REGULATING AIR FLOW DIRECTION

Adjust the air louvers by hand to control the air flow direction. (Fig. 23).

## SELF-DIAGNOSIS

This machine is equipped with self-diagnosis function. If something is wrong in the machine, the LCD will show the word “E1” or “E2”. As this time, please call your service center.

To prolong the compressor's life, after switch-off of the unit, please wait for 3 minutes (at least) before re-switch.

The cooling system will switch off if the ambient temperature is lower than the set one. The ventilation, however, keeps working on the set level. If the ambient temperature rises above the selected level. The cooling will return to work.

## DRAINAGE

During the process of cooling, some water will be extracted from the air into the unit. If the tank is full, both of the compressor and motor will stop. The "water full" sign will light on, also the machine will beep as reminder.

To make the cooling work again, please empty the water by one of the following ways:

### Fig. 19

1. Turn off the air conditioner and avoid moving it when full.
2. Position a container (a water tray for example) underneath the drain hole.
3. Remove the drain knob & rubber plug from the drain hole and allow the water to drain out.
4. When the container is almost full, replace the rubber plug in the drain hole and empty the water tray.
5. Repeat until the unit is emptied.
6. Replace the rubber plug and tighten the drain knob firmly.
7. Switch on the unit - the full water or compressor operating indicator should not be flashing.

If you wish to operate the unit without the need to empty the water tank, please:

### Fig 20.

- Remove the drain knob and rubber plug and retain for future use.
- Connect the drain tube supplied to the water outlet as shown and locate the other end into a drain.

### Fig. 21.

The drain tube may be extended by adding an extension tube and using a suitable connector.

### Please note (Fig. 22.)

1. The drain must be at or below the outlet level.
2. Flashing comp/'full water' indicator will not function in this mode of drainage.
3. If you want to extend the water tube, you can connect it with another tube (OD: 18mm)

## MAINTENANCE

**Always unplug the air conditioner from the mains before cleaning. To maximize the efficiency of the air conditioner clean regularly.**

## CLEANING THE HOUSING

Use a soft, damp cloth to wipe the body clean. Never use aggressive chemicals, gasoline, detergents, chemically treated cloths, or other cleansing solutions. These all could possibly damage the cabinet.

## CLEANING THE FILTER

Use a vacuum cleaner or tap the filter lightly to remove loose dust and dirt from the filters and then rinse thoroughly under running water (no hotter than 40°C).

Dry thoroughly before replacing.

*Notice!* Never operate the unit without the filters.

## END OF SEASON STORAGE

- Drain any water in the unit before completely operating the unit on ventilation only mode for a few hours, to thoroughly dry the inside.
- Clean or change the filter
- Unplug and store the power cord as shown
- Cover the cord storage
- Replace in the original carton or cover for storage

## FAULT CHECK LIST

*The air conditioner does not run:*

Is the air conditioner plugged in? Is

there a power failure?

Is the comp/'full water' indicator flashing?

Is the room temperature below the set temperature?

*The machine seems to do little:*

Is there direct sunshine? (Please put down the curtain.)

Are too many windows or doors open?

Are there too many people in the room?

Is there something in the room producing lots of heat?

*The machine seems to do nothing:*

Is the filter dusty, contaminated?

Is the air intake or output blocked up?

Is the room temperature below your selected temperature?

*Too noisy:*

Is the machine positioned unevenly so as to create vibration?

Is the floor underneath the machine uneven?

*The compressor doesn't run:*

If so, it is possible the overheat protection of the compressor is on. Just wait for the temperature to drop.

**Never try to repair or dismantle the unit yourself**



This marking indicates that this product should not be disposed with other household wastes throughout the EU. To prevent possible harm to the environment or human health from uncontrolled waste disposal. Recycle it responsibly to promote the sustainable reuse of material resources. To return your used device. Please use the return and collection systems or contact the retailer where the product was purchased. They can take this product for environmentally safe recycling.

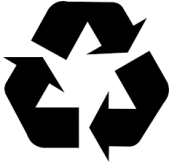

**ENVIRONMENTAL PROTECTION:** Please recycle any unwanted materials as opposed to disposing them as general waste. It is recommended the original is retained and used to store the product when not in use for prolonged periods of time. If this is not applicable ensure the materials are sorted and recycled in accordance with local regulations.

**SPECIFICATION CHANGE:** It is out policy to continually improve products to ensure these meet the rigours of the industry we serve. Therefore as such we reserve the right to alter specifications, data and components parts without prior notice.

**WARRANTY:** All Simply Spares products come with a 1 year warranty from date of purchase, proof of which will be required in the event of any claim.

**IMPORTANT:** No liability will be accepted for the incorrect use of this product.



Simply Spares & Consumables (UK) Limited  
8 Hooley Close, Long Eaton. Nottingham,  
NG10 3NU, UK

**SIMPLYSPARESUK.COM**



## Recycling



**ENVIRONMENTAL PROTECTION:** Please recycle any unwanted materials as opposed to disposing them as general waste. It is recommended the original is retained and used to store the product when not in use for prolonged periods of time. If this is not applicable ensure the materials are sorted and recycled in accordance with local regulations.



**SPECIFICATION CHANGE:** It is our policy to continually improve products to ensure these meet the rigours of the industry we serve. Therefore, as such we reserve the right to alter specifications, data, components & parts with-out prior notice.

**WARRANTY:** Please refer to the manufactures terms & conditions.

**IMPORTANT:** No liability will be accepted for the incorrect use of this product.

### KEEP THIS BOOKLET FOR FUTURE REFERENCE

📞 Nottingham: 0115 946 1988 • London: 0208 830 3333    ✉ Nottingham: [sales@hscgroupuk.co.uk](mailto:sales@hscgroupuk.co.uk) • London: [sean@hscgroupuk.co.uk](mailto:sean@hscgroupuk.co.uk)    🌐 [www.hscgroupuk.co.uk](http://www.hscgroupuk.co.uk)

The Hire Supply Company Terms & Conditions Apply At All Time E&OE